

LPAI

WITH KEYWAY MOUNTING

500 - 24,000 Nm

API 610 - IMPERIAL (API 671 OPTIONAL)

PROPERTIES

FEATURES

- ▶ lateral mounting without moving hubs
- ▶ integral safety catch in case of disc pack rupture
- ▶ balanced in accordance with ANSI / AGMA 9000 class 9

MATERIAL

- ▶ **Disc packs:** highly elastic, corrosion resistant spring steel

- ▶ **Hubs and spacer:** high strength steel

DESIGN

Two precision machined coupling hubs and precision spacer tube mounted to the disc packs by means of high strength screws and bushings for alignment and frictional clamping of the assembly. Axial retention with DIN 916 set screws (interference fit on request).

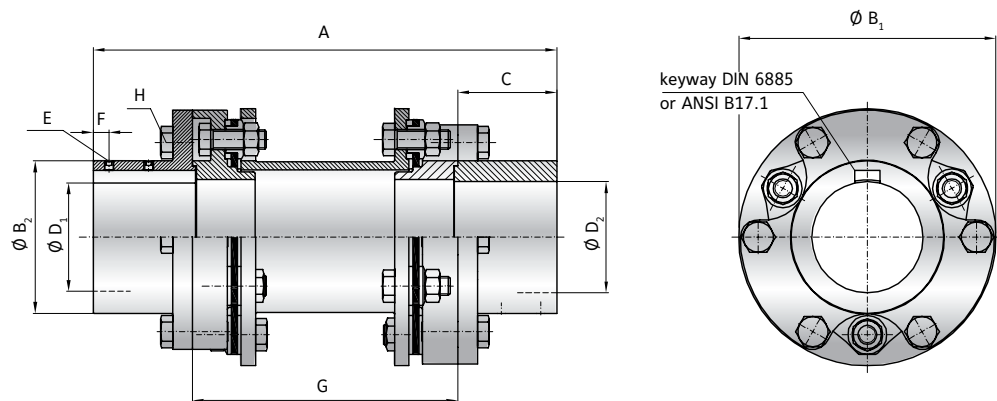

MODEL LPAI | SIZE 500 - 12000

SIZE	500		800		2500		5000		8000		12000	
Rated torque (kW/100rpm)	5		8		26.2		52		84		126	
Rated torque (Nm)	500		800		2500		5000		8000		12000	
Maximum torque (Nm)	1000		1600		5000		10000		16000		24000	
Overall length (mm)	A	217 268	237 288	330 381	358 409	429	479					
Outside diameter (mm)	B ₁	116	142	190	231	298	324					
Hub diameter (mm)	B ₂	71	84	102	130	160	192					
Hub fit length (mm)	C	45	55	75	90	100	125					
Bore diameter available from Ø to Ø H7 (mm)	D _{1/2}	23 - 50	25 - 60	31 - 75	39 - 95	50 - 115	70 - 140					
Set screw	E	2 × 1/4"-20	2 × 1/4"-20	2 × 5/8"-11	2 × 3/8"-16	2 × 1/2"-13	2 × 1/2"-13					
Distance (mm)	F	7	10	14	15	15	20					
Spacer length (mm)/(in.)	G	127/5" 178/7"	127/5" 178/7"	178/7" 229/9"	178/7" 229/9"	229/9"	229/9"					
Assembly screw, bolt and nut (Grade 9)	H	5/16"-18	3/8"-16	5/8"-11	3/4"-10	1"-8	1"-8					
Tightening torque (Nm)		38	68	320	595	1100	1100					
Moment of inertia (10 ⁻³ kgm ²)		8.3 8.8	21 22.3	85 87	248 254	890	1344					
Material		Steel	Steel	Steel	Steel	Steel	Steel					
Approximate weight (kg)		5.3 5.7	9.1 9.6	20.8 21.6	38.9 40	82.3	104					
Axial ± (mm)		0.75	1	1.3	1.5	1.7	2					
Lateral ± (mm)		1 1.5	0.9 1.4	1.3 1.8	1.1 1.6	1.3	1.3					
Angular ± (degree)		1°	1°	1°	1°	1°	1°					
maximum speed (1/min.)		7600	6400	5300	3900	3100	2500					
maximum speed (balanced) (1/min.)		18800	15100	12800	9800	8100	6200					

ORDERING EXAMPLE	LPAI	800	237	25.4	50.8	XX
Model	●					
Size		●				
Overall length mm			●			
Bore D1 H7				●		
Bore D2 H7					●	
Special designation only (e.g. special hub for large bore).						
For custom features place an XX at the end of the part number and describe the special requirements (e.g. LPAI / 800 / 237 / 41.28 / 19 / XX; XX = D2 interference fit)						

DISC PACK COUPLINGS LP