



WITH FULLY SPLIT CLAMPING HUB

15 - 4,000 Nm

ABOUT



FEATURES

- ▶ radial mounting possible
- ▶ easy installation onto pre-aligned shafts
- ▶ low moment of inertia

DESIGN

Two split clamping hubs with two screws in each. Brief overloads of up to 1.5x the rated torque are acceptable.

MATERIAL

- ▶ **Bellows:** high grade stainless steel
- ▶ **Hubs:** see table

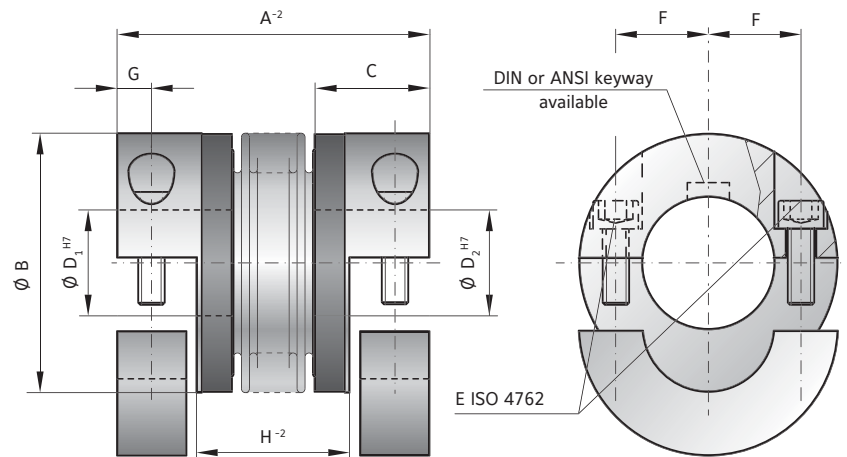

BELLOWS COUPLINGS BK

MODEL BKH

SIZE		15	30	60	80	150	200	300	500	800	1500	4000
Rated torque (Nm)	T _{KN}	15	30	60	80	150	200	300	500	800	1500	4000
Overall length (mm)	A ⁻²	59 66	69 77	83 93	94 106	95 107	105 117	111 125	133 146	140	166	225
Outside diameter (mm)	B	49	55	66	81	81	90	110	124	134	157	200
Fit length (mm)	C	22	27	31	36	36	41	43	51	45	55	85
Inside diameter possible from Ø to Ø H7 (mm)	D ₁ /D ₂	8-28	10-30	12-35	14-42	19-42	22-45	24-60	35-60	40-75	50-80	50-90
Fastening screw ISO 4762		M5	M6	M8	M10	M10	M12	M12	M16	M16	M20	M24
Tightening torque of the fastening screw (Nm)	E	8	15	40	50	70	120	130	200	250	470	1200
Distance between centerlines (mm)	F	17	19	23	27	27	31	39	41	48	55	65
Distance (mm)	G	6.5	7.5	9.5	11	11	12.5	13	16.5	18	22.5	28
Distance (mm)	H ⁻²	29 36	35 43	41 51	47 59	48 60	51 63	55 69	62 75	65.5	71	107
Moment of inertia (10 ⁻³ kgm ²)	J _{res}	0.07 0.08	0.14 0.15	0.23 0.26	0.65 0.67	2.5 3.2	4.5 5.4	8.5 10.5	17.3 19.6	24.3	49.2	165
Hub material		Al optional steel	Al optional steel	Al optional steel	Al optional steel	steel optional AL	steel optional AL	steel optional AL	steel optional AL	steel	steel	steel
Approximate weight (kg)		0.15	0.3	0.4	0.8	1.7	2.5	4	7.5	7	12	28
Torsional stiffness (10 ³ Nm/rad)	C _t	20 15	39 28	76 55	129 85	175 110	191 140	450 350	510 500	780	1304	3400
Axial ± (mm)	Max. values	1 2	1 2	1.5 2	2 3	2 3	2 3	2.5 3.5	2.5 3.5	3.5	3.5	3.5
Lateral ± (mm)		0.15 0.2	0.2 0.25	0.2 0.25	0.2 0.25	0.2 0.25	0.25 0.3	0.25 0.3	0.3 0.35	0.3 0.35	0.35	0.35
Angular ± (degree)		1 1.5	1 1.5	1 1.5	1 1.5	1 1.5	1 1.5	1 1.5	1 1.5	1 1.5	1.5	1.5
Axial spring stiffness (N/mm)	C _a	25 15	50 30	72 48	48 32	82 52	90 60	105 71	70 48	100	320	565
Lateral spring stiffness (N/mm)	C _r	475 137	900 270	1200 420	920 290	1550 435	2040 610	3750 1050	2500 840	2000	3600	6070

ORDERING EXAMPLE	BK2 / BKH	80	94	20	22.23	XX
Model	●					
Size		●				
Overall length mm			●			Special designation only (e.g. anodized hubs).
Bore D1 H7				●		
Bore D2 H7					●	

For custom features place an XX at the end of the part number and describe the special requirements (e.g. BKH / 80 / 94 / 20 / 22.23 / XX; XX=finely balanced for 25,000 rpm)