

50 Series End Mount

NEMA Frame Size 48C
Torque Ratings: 1.5 to 6 lb-ft

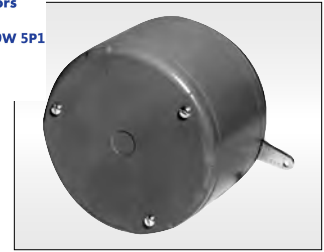

Ideal for OEM applications and brake kits

Specifications:

Reaction Time: 15-20 milliseconds
 (release and set)

AK: 3" Register

AJ: 3.75" Bolt Circle

Thermal Capacity: 4 HPS/MIN

Maximum RPM: 3600

CSA File #LR13814

Coil insulation: Class B Standard,
 Class H Optional

Instructions & Parts Manual: BK4618

Enclosure Type:

Dripproof Enclosure

NEMA 2, IP40

Steel cover and mounting bracket

Design Features:

RoHS compliant

Torque adjustable for specific applications

Spring set, electrically released

Deadman release (Available without release)

Splined hub

Through shaft knockout standard, all models

Torque lb-ft	Model # Internal lead connection	Replaces Stearns® Model Number	List Price Internal lead connection	Model # Internal/external lead connection	Replaces Stearns® Model Number	List Price Internal/external lead connection	Wt Lbs.	Inertia Wk ² lb-ft ²	Manual Release*
1.5	51001-050	1-048-151-01	\$380	51001-080	1-048-151-00	\$420	7	0.002	Yes*
3	51003-050	1-048-161-01	\$395	51003-080	1-048-161-00	\$435	7	0.002	Yes*
6	51006-050	1-048-171-01	\$410	51006-080	1-048-171-00	\$450	7	0.002	Yes*

*For brakes without manual release, use model 5xxxx-05A or 5xxxx-08A. Stearns® is a registered trademark of Rexnord Corporation.

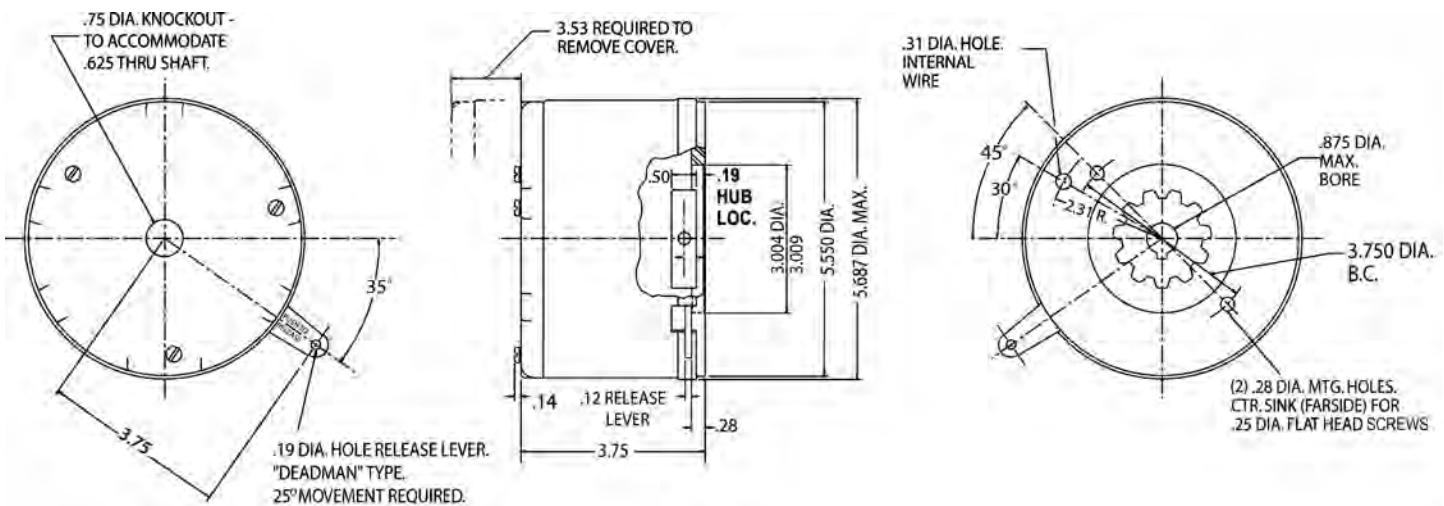

Brake Model Number Definition

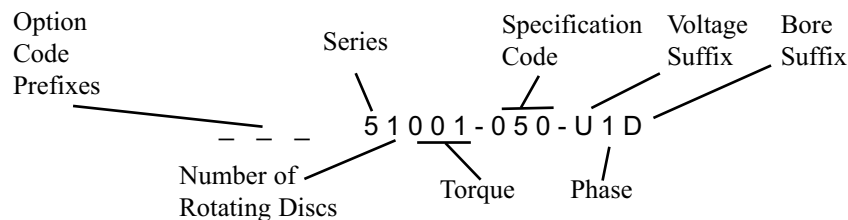

Standard Voltages (single phase only):

Suffix	Voltage
U	230/460V, 60 Hz or 190/380V, 50 Hz
R	115/230V, 60 Hz
T	220/440V, 60 Hz
P	575V, 60 Hz

Special voltages available.

Standard Hub Bore Sizes:

Suffix	Size	Keyway
D	5/8"	3/16" x 3/32"

Special bore sizes available.

Available Options:

Option	Prefix
Adapter to Larger Frame Size(s)	A
Direct Current (DC Voltage)	DD
Tropical Protection	P
Class H Insulation	Q

Refer to pages 51-56 for option descriptions and pricing.